

Haglof Link

Field data hub

Wireless communication and data capture in the field



Collect and share data wireless

Haglof Link is an application for communication with Haglöf Sweden's field instrument via Bluetooth.

Haglof Link is available for both iOS and Android platforms.

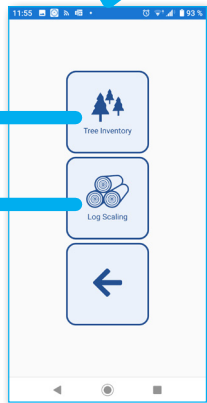
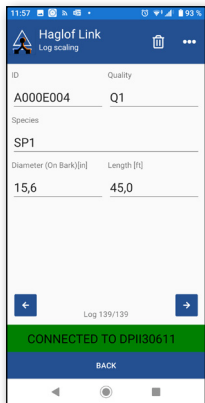
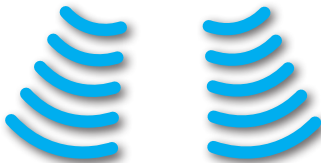
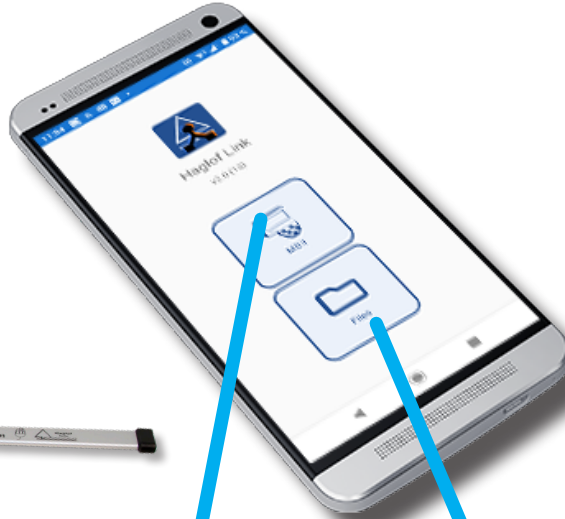

Compatible instruments

Haglof Link is compatible with units using Bluetooth 4.0 Low Energy:

- Mantax Digitech (MD II) from serial number: 35500
- Digitech Professional (DP II) from serial number: 35500
- Vertex Lase Geo*
- Laser Geo*

* Vertex Laser Geo before serial number: VL60602 and Laser Geo before serial number: L60341 may need to upgrade the Bluetooth firmware, if so contact us.

It's Free

Available for download on App Store or Google play.





MD II - Haglof Link

There are two options to use Haglof Link together with the MD II Caliper. Collect and receive data wireless as you do the measuring work or receive a complete file wireless that has been stored locally in the MD II caliper.



MD II

Use MD II^{4.0} in **LINE** mode and collect data wireless as you measure.

- Choose **Tree inventory** or **Log Scaling**.
- Create a new inventory list or select an existing list.
- Connect the MD II and start measuring.



Tree Inventory

Use MD II^{4.0} in LINE mode and collect tree data wireless as you do the Timber

Cruising.

MD II transmit **Species name, Diameter** and **Heights** to Haglof Link.

Haglof Link Tree inventory	
Species	
SP2	
Diameter [in]	Height 1 [ft]
9,5	0,0
Height 2 [ft]	Height 3 [ft]
0,0	0,0



Log Scaling

Use MD II^{4.0} in LINE mode and collect data wireless as you measure the logs.

MD II transmit **Species name, Diameter, Length, ID, and Quality** to Haglof Link.

Haglof Link Log scaling	
ID	Quality
A000E004	Q1
Species	
SP1	
Diameter (on Bark)[in]	Length [ft]
15,6	45,0

Each inventory list is stored in Haglof Link on your device as an XML file. Any list can then be shared via email, Drop- box, iCloud, Google Drive or similar directly from the app.



Files

- Use MD II^{4.0} in **LOCAL** mode and data is stored locally in the MD II as an XML file.

Once your work is done, send the file to Haglof Link **Files**. This files will be stored in Haglof Link file explorer and can be shared via email, Drop- box, iCloud, Google Drive or similar directly from the app.

The files can be opened directly from Haglof Link if you have an app that supports the file format as **Excel**.

Haglof Link Files	
Truck load 11.2019-11-14 09:11:40.MDII.XML	
50kb	1971-10-03 22:44:22
STAND 1244.2019-11-27 13:01:05.MDII.XML	
19kb	1971-10-03 22:44:22
2019-11-14,110834.MDII.XML	
5kb	1971-10-03 22:44:22
DATA.CSV	
814b	1971-10-03 22:44:22
TRAIL1.CSV	
847b	1971-10-03 22:44:22
MAP1.CSV	
11kb	1971-10-03 22:44:22
MAP2.CSV	
482b	1971-10-03 22:44:22
DATA.KML	
321b	1971-10-03 22:44:22
TRAIL1.KML	
48b	1971-10-03 22:44:22
MAP1.KML	
75kb	1971-10-03 22:44:22
BACK	START RECEIVING

Geo instruments - Haglof Link

- Measurements made with all Geo instruments can be saved in the internal memory. Data is stored in file formats **CSV** and **KML**.

Once your work is done, send the files wireless to Haglof Link Files. The files will be stored in Haglof Link and can be shared via email, Drop- box, iCloud, Google Drive or similar directly from the app.

The files can be opened directly from Haglof Link if you have an app that supports the file format. For example, **Earth** can be used to open **KML** and **Excel** for **CSV** files.

Upload files

Pits and Piles 3D

If an irregular pile is measured, you can easily upload the file from Haglof Link to **Pits & Pile 3D**.

You will then, directly out in the field, see results as volume and weight etc.

Remember to first create a free account on Pits and Pile 3D.

Read more about Pits and Piles 3D at www.haglof.app



Haglöf Sweden AB

Klockargatan 8, 882 30 Långsele, Sweden

Phone: +46 620 255 80

Email: info@haglofsweden.com

www.haglofsweden.com